



Webbs

Helping people move since 1894

**Stuart Street | Walsall | WS3 2DX**

**Offers Over £220,000**



## Summary

**\*\* SEMI DETACHED HOUSE \*\* NO ONWARD CHAIN \*\* DECEPTIVELY SPACIOUS \*\* TWO RECEPTION ROOMS \*\* INTERNAL VIEWING ADVISED \*\* THREE FIRST FLOOR BEDROOMS \*\* REFITTED BATHROOM \*\* SEPARATE WC \*\* REFITTED KITCHEN \*\* LIVING ROOM \*\* DINING ROOM \*\* ENCLOSED REAR GARDEN \*\* UPVC DOUBLE GLAZING \*\* GAS CENTRAL HEATING \*\* POPULAR AND CONVENIENT LOCATION CLOSE TO SCHOOLS , SHOPS AND AMENITIES \*\* EARLY VIEWING ADVISED \*\***

Webbs Estate Agents have pleasure in offering this deceptively spacious semi detached home and offering no onward chain. The property is situated in a popular and convenient location, being close to all local amenities, shops and schools. Briefly comprising on the ground floor : Entrance hall, living room, dining room and a refitted kitchen. The first floor landing leads to three bedrooms and a refitted family bathroom with separate WC. Externally there is a front garden with an enclosed garden to the rear with storage unit. For a viewing please call NOW.

## Key Features

- NO ONWARD CHAIN
- POPULAR LOCATION CLOSE TO AMENITIES
- LIVING ROOM
- REFITTED KITCHEN
- GARDENS
- SEMI DETACHED
- 3 BEDROOMS
- DINING ROOM
- REFITTED BATHROOM, SEPARATE WC
- EARLY VIEWING ADVISED

## Rooms and Dimensions

### ENTRANCE HALL

### LIVING ROOM

13'6" x 13'1" (4.14 x 4.01)

### DINING ROOM

10'6" x 8'1" (3.22 x 2.47)

### REFITTED KITCHEN

10'2" x 8'5" (3.10 x 2.57)

### FIRST FLOOR LANDING

### BEDROOM ONE

13'1" x 11'6" (4.01 x 3.53)

### BEDROOM TWO

12'5" x 10'7" (3.81 x 3.25)

### BEDROOM THREE

8'4" x 8'3" (2.56 x 2.54)

### REFITTED BATHROOM

5'11" x 4'10" (1.81 x 1.48)

### SEPARATE WC

### OUTSIDE

### Identification Checks

### Premium Conveyancing (B)





GROUND FLOOR

1ST FLOOR

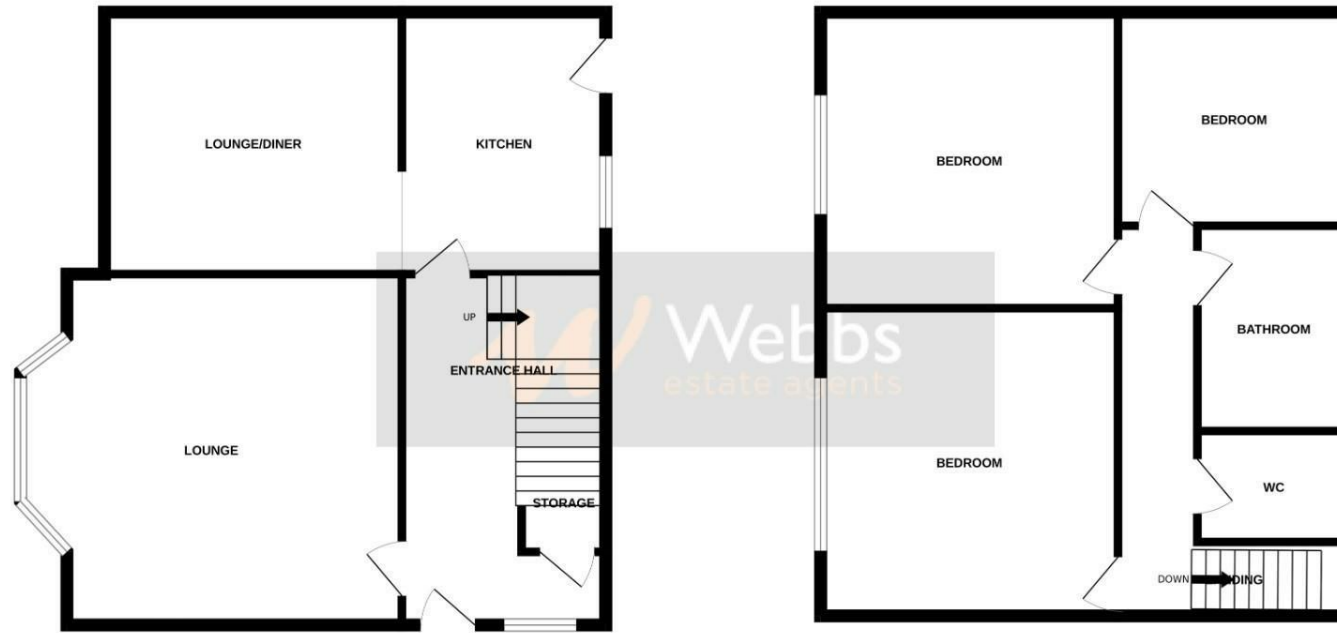

Whilst every attempt has been made to ensure the accuracy of the floorplan contained here, measurements of doors, windows, rooms and any other items are approximate and no responsibility is taken for any error, omission or mis-statement. This plan is for illustrative purposes only and should be used as such by any prospective purchaser. The services, systems and appliances shown have not been tested and no guarantee as to their operability or efficiency can be given.  
Made with Metropix ©2026

Webbs Estate Agents - endeavour to maintain accurate depictions of properties in Virtual Tours, Floor Plans and descriptions, however, these are intended only as a guide and purchasers must satisfy themselves by personal inspection.

